

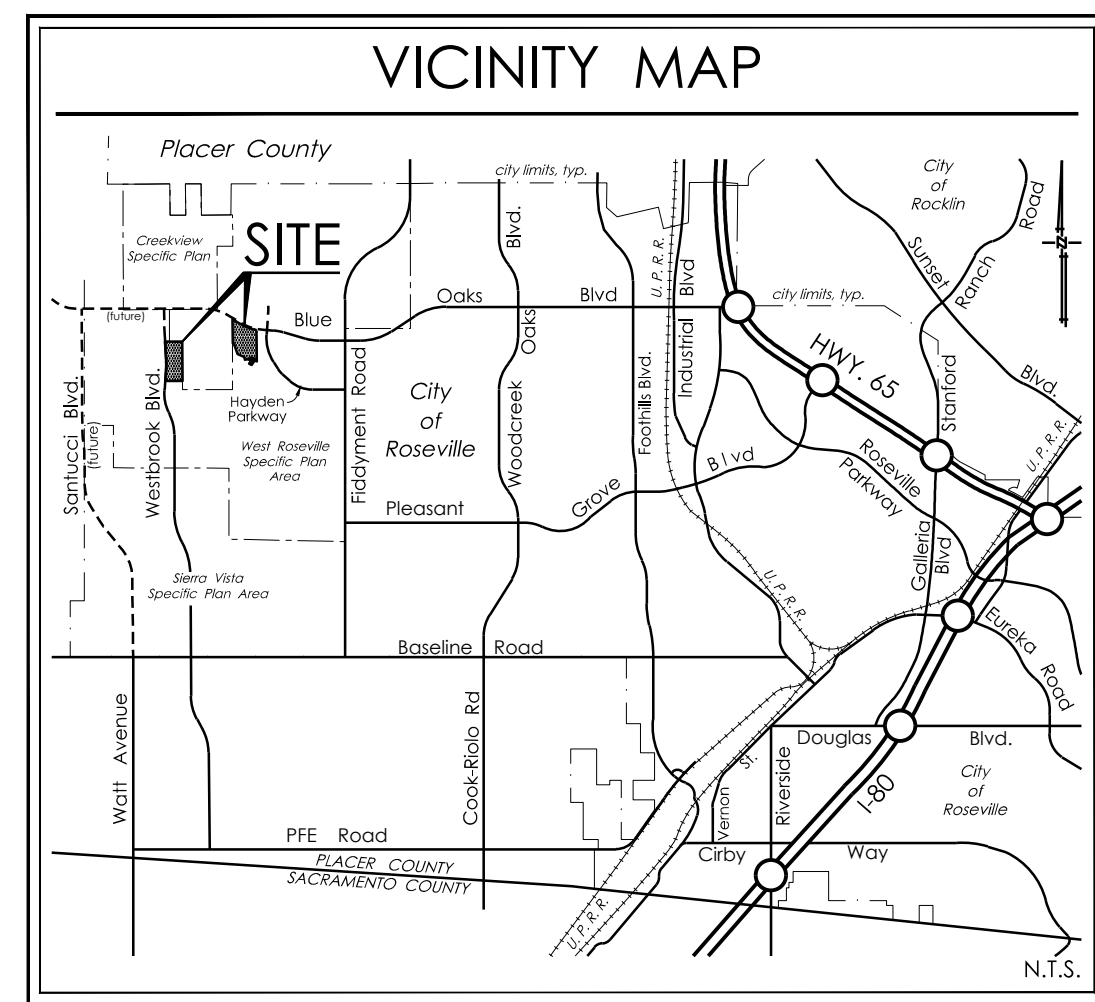

EXISTING LAND USE



PROPOSED LAND USE



LAND USE SUMMARY		
Existing Land Use		
Parcel	Land Use	Acres
F-55	P/R (Parks & Recreation)	29.80 ac.
W-60a	LI (Light Industrial)	25.20 ac.
TOTAL		55.00 ac.
Proposed Land Use		
Parcel	Land Use	Acres
F-55a	LDR (Low Density Residential)	24.28 ac.
F-55b	P/R (Parks & Recreation)	4.03 ac.
F-86b	OS (Open Space)	0.81 ac.
F-86c	OS (Open Space)	0.05 ac.
F-20b	HDR (High Density Residential)	0.49 ac.
W-60a	P/R (Parks & Recreation)	25.20 ac.
ROW	Right of Way	0.14 ac.
TOTAL		55.00 ac.

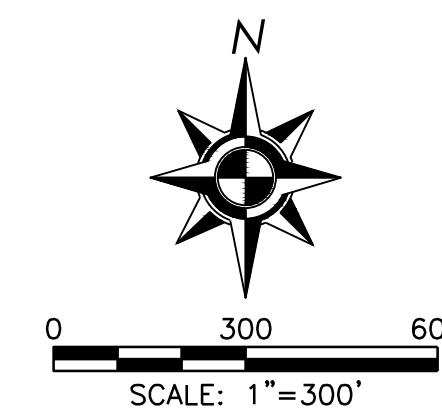

GENERAL PLAN AMENDMENT &
SPECIFIC PLAN AMENDMENT EXHIBIT
Parcels F-55 & W-60a
of the West Roseville Specific Plan
Roseville, CA December 11, 2019



1/17/2019 14:38:24 acrc P:\18424_L250\PA\MapStation\GPA-SPA-2019-2027-F55-GPA-SPA-2019-2027-Schem_03 - 02/11/2019 09:58:09
 7/17/18424_L250\PA\MapStation\GPA-SPA-2019-2027-F55-GPA-SPA-2019-2027-Schem_03 - 02/11/2019 09:58:09